





HANDLEBAR RISERS/SETBACKS—GL1800

7438

THANK YOU FOR CHOOSING KÜRYAKYN!

PROTECT YOURSELF AND OTHERS FROM POSSIBLE INJURY AND PROPERTY DAMAGE OR LOSS. PAY CLOSE ATTENTION TO ALL INSTRUCTIONS, WARNINGS, CAUTIONS, AND NOTICES REGARDING THE INSTALLATION, USE, AND CARE OF THIS PRODUCT.

 WARNING	THIS INDICATION ALERTS YOU TO THE FACT THAT IGNORING THE CONTENTS DESCRIBED HEREIN CAN RESULT IN POTENTIAL DEATH OR SERIOUS INJURY.
 CAUTION	This indication alerts you to the fact that ignoring the contents described herein can result in minor or moderate potential injury.
 NOTICE	This indication alerts you to the fact that ignoring the contents described herein may negatively affect product performance and functionality or damage the product itself or the product to which it is being attached.

MAKE SURE THE FOLLOWING PARTS HAVE BEEN INCLUDED IN THE KIT:

- 1 Right Riser/Setback Block
- 1 Left Riser/Setback Block
- 2 Riser Shims
- 1 Hardware Kit containing:
 - 2 Black Plugs
 - 4 M10 Flat Washers
 - 4 M10 X 1.5 X 25MM Hex Bolt
- 1 Installation Instructions

TOOLS SUGGESTED:

Metric socket set and ratchet, metric hex wrenches, ft-lbs (Nm) torque wrench.

 **NOTICE**

These installation instructions contain important information. Ensure that the end user receives this copy and is aware of its importance for future reference.

 **WARNING**

THE END USER'S SAFETY DEPENDS UPON PROPER INSTALLATION OF THIS PRODUCT. IF A STEP IN THIS SET OF INSTRUCTIONS IS NOT WITHIN YOUR CAPABILITIES OR YOU DO NOT HAVE THE CORRECT TOOLS, HAVE YOUR DEALER PERFORM THE PROCEDURE. IMPROPER INSTALLATION OF THIS PRODUCT COULD RESULT IN DEATH OR SERIOUS INJURY.

CUSTOMER SERVICE

877.370.3604 (toll free)

INSTALLATION QUESTIONS

techsupport@kuryakyn.com
or call 715.247.2983

LIMITED WARRANTY

Kuryakyn warrants that any Kuryakyn products sold hereunder, shall be free of defects in materials and workmanship for a period of one (1) year from the date of purchase by the consumer excepting the following provisions:

- Kuryakyn shall have no obligation in the event the customer is unable to provide a receipt showing the date the customer purchased the product(s).
 - The product must be properly installed, maintained and operated under normal conditions.
 - Kuryakyn makes no warranty, expressed or implied, with respect to any gold plated products.
 - Kuryakyn shall not be liable for any consequential and incidental damages, including labor and paint, resulting from failure of a Kuryakyn product, failure to deliver, delay in delivery, delivery in nonconforming condition, or for any breach of contract or duty between Kuryakyn and a customer.
- Kuryakyn products are often intended for use in specific applications. Kuryakyn makes no warranty if a Kuryakyn product is used in applications other than intended.
- Kuryakyn electrical products are warranted for one (1) year from the date of purchase by the consumer. L.E.D.'S contained in components of Kuryakyn products will be warranted for defects in materials and workmanship for 3 years from the date of purchase where as all other components shall be warranted for one(1) year. This includes, but is not limited to; control modules, wiring, chrome & other components.

- Kuryakyn makes no warranty of any kind in regard to other manufacturer's products distributed by Kuryakyn. Kuryakyn will pass on all warranties made by the manufacturer and where possible, will expedite the claim on behalf of the customer, but ultimately, responsibility for disposition of the warranty claim lies with the manufacturer.

ABOUT OUR CATALOG

For purchasing Kuryakyn® products, you can receive a complete catalog free of charge. Send the Proof-of-Purchase below with your address to: Kuryakyn
454 County Road V V
Somerset, WI 54025-9031
Please indicate either Accessories Catalog for Harley-Davidson® or GL & Metric Cruisers.

Be sure to ask your local dealer about other Kuryakyn® products, the motorcycle parts and accessories designed for riders by riders.

©2005 Kuryakyn USA® All Rights reserved.





ACCIDENTAL VEHICLE START-UP COULD CAUSE DEATH OR SERIOUS INJURY, REMOVE THE MAIN FUSE BEFORE PROCEEDING.

Kuryakyn

STEP 1 Read and understand all steps in the instructions before starting the installation. Park the motorcycle on a hard, level surface and turn off the ignition. Put the bike on its center stand (if equipped) or secure it in a motorcycle wheel chock. **Remove the main fuse.**

BIKE PREP:

NOTICE

Avoid damage to the motorcycle. Protect painted surfaces with a soft cloth or service cover.

'01-'05 MODELS:

STEP 2 Remove the speaker covers. They are held in place by four plastic spring tabs; remove the covers by gently pulling up and outward on the bottom edge of the speaker cover. Remove the hex screws and trim pins shown in **PIC 1**. Set the covers and hardware aside for now.

STEP 3 Gently lift up on the meter panel starting at the bottom. There are posts that fit into rubber grommets holding it in place. Unplug the wire harness and set the meter panel on a soft sturdy surface.

STEP 4 Refer to **PIC 5**. Remove the two fasteners securing the handlebar center cover; remove the cover. Set the cover and screws aside for now.

Move on to **STEP 10**.

'06-UP MODELS:

STEP 5 Refer to **PIC 2**. Remove the ignition switch cover.

STEP 6 Refer to **PIC 3**. Disconnect the meter panel by gently pulling upward at the bottom to release the pins; gently pull the top towards you to release the tabs.

STEP 7 Refer to **PIC 4**. Disconnect the connector behind the panel at the bottom. Refer to **PIC 5**. At the top of the panel, pull the rubber boot away from each tweeter speaker and disconnect the connector. Set the dash on a soft, sturdy surface.

STEP 8 Remove the four display assembly screws and two washers from the locations shown in **PIC 6**; set them aside for now.

STEP 9 Refer to **PIC 7**. Lift up on the display assembly and remove the two screws securing the handlebar center cover; set the cover aside for now.

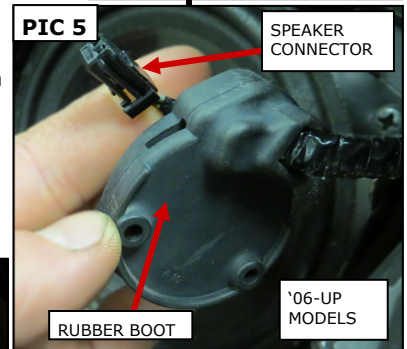
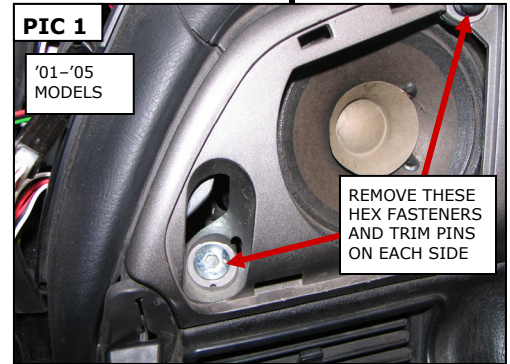

-cont.-

STEP 10

Remove the two OEM bolts securing the clutch-side handlebar; gently rest the handlebar on the blanket or service cover for now.

Kuryakyn®

NOTE:

Refer to PICs 8, 9, and 10 to determine the orientation of the block **or** shim for your desired handlebar position. Set the desired components and included M10 bolts (or OEM bolts) and washers within arms reach of the work area.

WARNING

THE BLOCKS AND SHIMS ARE DESIGNED TO BE INSTALLED **SEPARATELY**. **DO NOT COMBINE THEM IN ANY WAY**. IMPROPER INSTALLATION CAN CAUSE FASTENER FAILURE RESULTING IN LOSS OF CONTROL WHICH CAN CAUSE DEATH OR SERIOUS INJURY.

INSTALL THE BLOCKS:

STEP 11

Refer to **PIC 11** on **PAGE 4**. Loosen the clutch and brake line keepers at the base of the handlebars until the lines can move freely.

STEP 12

Refer to **PIC 8**. Attach the block (with the angle facing outward toward the rear) to the fork-top-bridge with the two OEM bolts from **STEP 10**. Torque the bolts to 20 ft lbs (26 Nm).

NOTICE

Avoid damage to the motorcycle. Protect painted surfaces with a soft cloth or service cover.

NOTE:

Refer to **PIC 12** on **PAGE 4**. Ensure that the cables and wires remain in their keepers on the under side of the bars before installing.

STEP 13

Position the handlebar over the block, align the holes and secure it with the included M10 bolts and washers.

STEP 14

Repeat **STEPS 10 through 13** for the other side.

STEP 15

Torque the four M10 bolts to 20 ft-lbs (26 Nm).

STEP 16

Tighten the clutch and brake line keepers. (The rubber locating bosses will not line up with the keepers).

STEP 17

Cover the exposed bolt holes with the included two Black Plugs. Move on to **STEP 23**.

or

INSTALL THE SHIMS:

STEP 18

Refer to **PICs 9 or 10**. Position the shim in the desired direction over the fork-top-bridge.

NOTE:

Refer to **PIC 12** on **PAGE 4**. Ensure that the cables and wires remain in their keepers on the under side of the bars before installing.

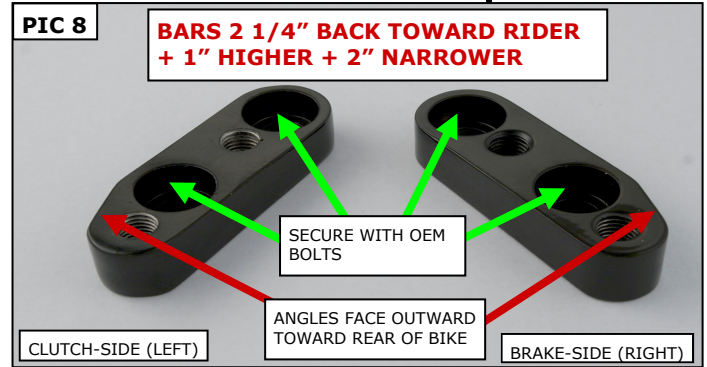

or

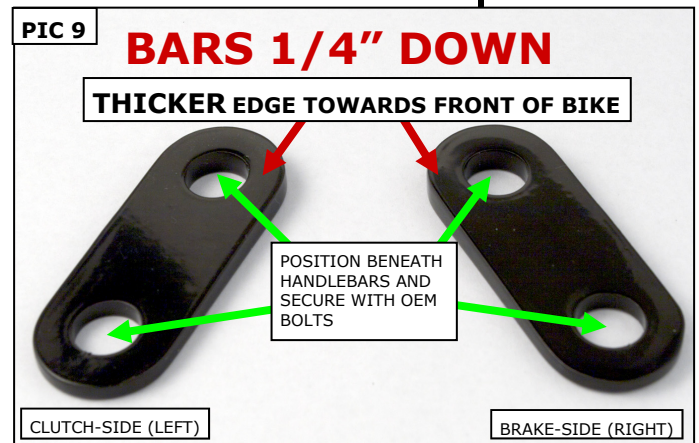

or

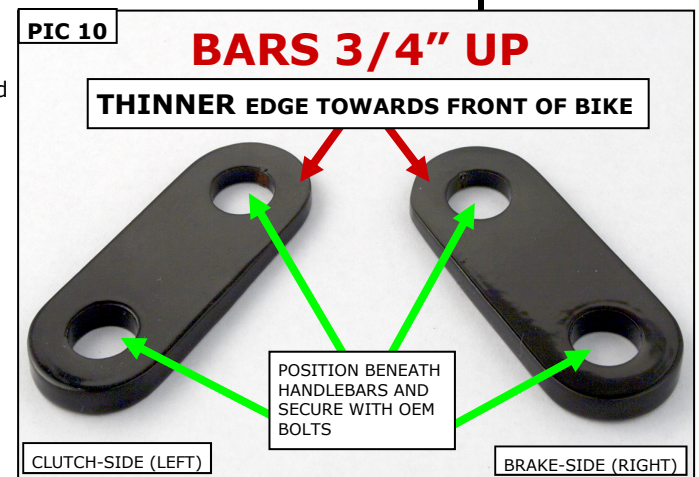

PAGE

3

-cont.-

- STEP 19** Position the handlebar over the shim, align the holes, and secure it with the OEM bolts.
- STEP 20** Repeat **STEPS 10, 18 and 19** for the other side.
- STEP 21** **Torque the OEM bolts to 20 ft-lbs (26 Nm).**
- STEP 22** Reinstall the handlebar center cover (**shim application only**).

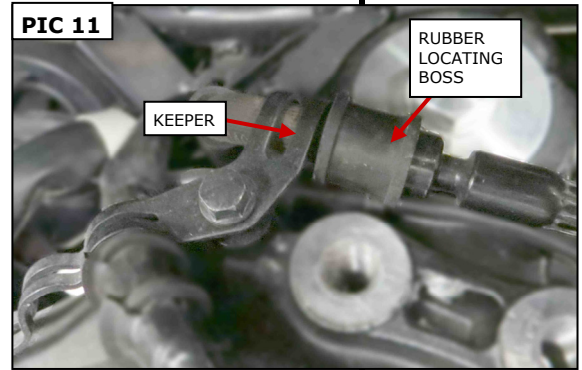

REASSEMBLY:

- STEP 23** Remove the motorcycle from the center stand or wheel chock. Turn the handlebars all the way left and right to their full stop positions to ensure there is no binding or interference. Make any necessary adjustments before finishing the installation or operating the motorcycle.
- STEP 24** Reinstall the display assembly (**'06-Up Models only**), meter panel, and any covers in the reverse order they were removed.
- STEP 25** Reinstall the main fuse.



NOTICE

It is the end user's responsibility to ensure that all of the fasteners (including pre-assembled) are tightened before operation of the motorcycle. Küryakyn will not provide warranty coverage on products or components lost due to improper installation or lack of maintenance. Periodic inspection and maintenance are required on all fasteners.

WARNING

THE M10 X 1.25 X 25MM BOLTS MUST HAVE THREADLOCK COMPOUND RE-APPLIED AND MUST BE TORQUED IF REMOVED AFTER INITIAL INSTALLATION. FAILURE TO DO SO MAY RESULT IN UNINTENDED LOOSENING WHICH COULD RESULT IN LOSS OF CONTROL CAUSING SERIOUS INJURY OR DEATH.

THE FEMALE THREADS IN THE RISER/SETBACK BLOCKS AND THE THREADS ON THE M10 X 1.25 X 25MM BOLTS WILL NEED TO BE CLEANED TO REMOVE ANY THREAD-LOCKER RESIDUE BEFORE RE-INSERTING.

RE-APPLY LOCTITE® THREADLOCKER BLUE 242® OR EQUIVALENT, AS SHOWN IN **PIC 13, TORQUE TO 20 FT-LBS (26 NM)** USING A TORQUE WRENCH. LET CURE PER THE THREADLOCK MANUFACTURERS INSTRUCTIONS AFTER INSTALLATION.

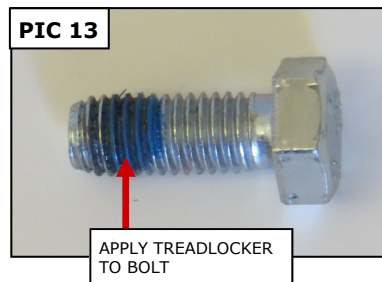

Ride On!