



Goldstrike Swingarm Covers

Parts Included:

- 1 Left side swingarm cover
- 1 Right side swingarm cover

Installation Instructions:

1. Park on a level surface and shut off the motorcycle. Ensure that the engine has time to cool before installation. Place on center stand if available.
2. Remove OEM Swingarm Pivot Cover. Set screws aside for reuse. (Fig. 1)

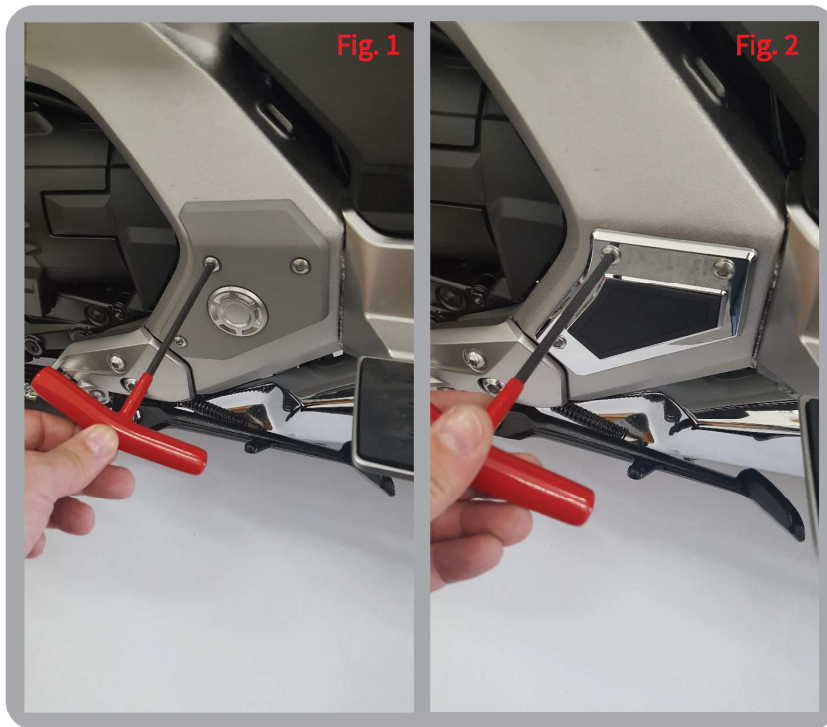

3. Determine correct orientation for the left and right sides of the motorcycle. Install covers using original screws, torque to 5.2 N-m, 3.8 ft-lbs. Do not overtighten. (Fig. 2)

WARNING:

This indication alerts you to the fact that ignoring the contents described herein can result in potential serious injury or death if not followed.

CAUTION:

This indication alerts you to the fact that ignoring the contents described herein can or will result in material damage and/or personal injury.

ATTENTION:

This indication alerts you to the fact if you ignore this detail you will affect the performance or functionality of the product.

All Ciro products are designed for "easy assembly" and/or "plug and play". We recommend a competent mechanic install our products, using standard mechanical procedures to assure a safe and successful installation.

NOTE:

Ciro products are designed and manufactured under very strict quality control. Ciro warrants that products sold to the original purchaser shall be free from any defects in materials and workmanship for a period of 3 (three) years from the date of purchase, and a lifetime warranty against LED failure.

Ciro will have no obligation if the customer cannot show proof of purchase.

Warranty will not be granted unless the part is properly installed and maintained.

Ciro will not be liable for any consequential and incidental damages, including labor, or non-Ciro products.

Please visit our website Ciro3d.com for our complete warranty policy.