

## INSTALLATION INSTRUCTIONS

PART NO. 52-949

BRAKE LIGHT MODULATOR

FITMENT: HONDA GOLDWING/GOLDWING TOUR 2018-NEWER

4/12/2019

TOOLS NEEDED: 6MM ALLEN WRENCH

WIRE CUTTER/CRIMPER

RUBBING ALCOHOL

CLEAN RAG

HEAT GUN

**PLEASE READ THROUGH AND UNDERSTAND THESE INSTRUCTIONS BEFORE BEGINNING.**

**ESTIMATED INSTALLATION TIME: 90 TO 120 MIN.**

### INSTALLATION:

1. OPEN BOTH SADDLEBAGS AND REMOVE LEFT AND RIGHT SIDE COVERS BY PULLING THEM STRAIGHT OUT FROM THE BIKE. (FIG. 1)
2. DISCONNECT THE SEAT HEATER HARNESS CONNECTOR FROM THE HOLDING CLIP (BEHIND RIGHT SIDE COVER) BY PRESSING THE LOWER CENTER TAB (FIG. 2) AND SLIDING THE CONNECTOR DOWN. PRESS THE UPPER CENTER LOCK TAB AND PULL THE CONNECTOR APART TO UNPLUG IT.
3. REMOVE THE TWO SEAT SCREWS WITH A 6MM ALLEN WRENCH (FIG. 3-LEFT SIDE SHOWN) AND REMOVE SEAT BY LIFTING THE FRONT AND PULLING THE SEAT FORWARD.
4. LOCATE THE LEFT AND RIGHT SADDLEBAG CONNECTORS (FIG. 4) AND DISCONNECT BOTH LEFT AND RIGHT SADDLEBAG CONNECTORS.
5. USING THE SUPPLIED BUTT CONNECTORS, CRIMP THE WIRES FROM THE BRAKE LIGHT MODULATOR TO THE WIRE HARNESS SUPPLIED (FIG. 5). (BLACK WIRE TO BLACK WIRE, RED WIRE TO RED WIRE, WHITE WIRE TO WHITE WIRE)
6. USING A HEAT GUN SHRINK THE ENDS OF EACH BUTT CONNECTOR TO THE WIRES.
7. CONNECT THE MODULATOR HARNESS INLINE WITH THE LEFT AND RIGHT SADDLEBAG CONNECTORS FROM STEP 5 AS SPECIFIED IN FIG. 5. **NOTE: IF YOU HAVE A TRAILER HARNESS OR OTHER ACCESSORY CONNECTED TO THE SADDLEBAG CONNECTORS, THE MODULATOR MUST BE CONNECTED IN LINE BEHIND ANY ADDED ACCESSORIES IN THE CIRCUIT (LAST THING IN THE CIRCUIT BEFORE THE TAIL LIGHTS).**
8. TEST THE FUNCTIONS OF MODULATOR AND TAIL LIGHTS. USE FIG. 6 TO SET THE FLASH PATTERN YOU WOULD LIKE TO USE.
9. FIND AN AREA TO MOUNT THE MODULATOR UNDER THE SEAT AND CLEAN WITH RUBBING ALCOHOL AND A CLEAN RAG. LET DRY COMPLETELY. (MAKE SURE PLACEMENT WONT INTERFERE WITH INSTALLING THE SEAT)
10. PEEL THE BACKER FROM THE DOUBLE SIDED TAPE ON THE MODULATOR AND PRESS IN PLACE TO SECURE ON BIKE.
11. REPEAT STEPS 1 THROUGH 3 IN REVERSE ORDER.

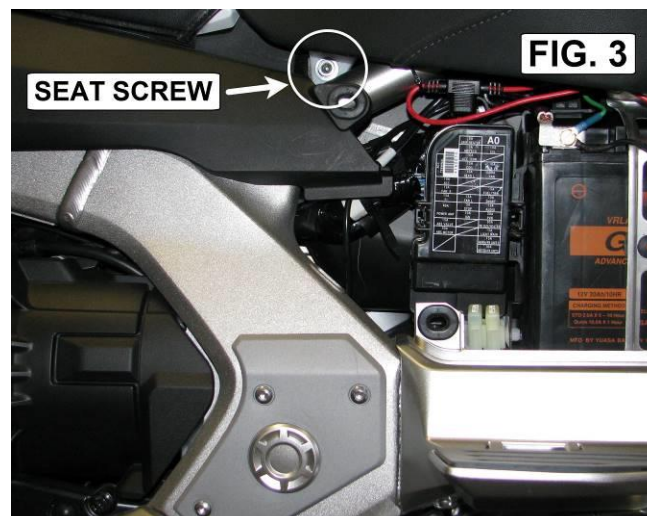
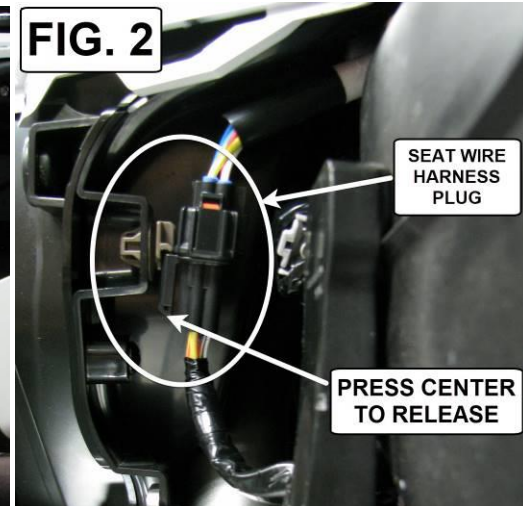

**FIG. 4**

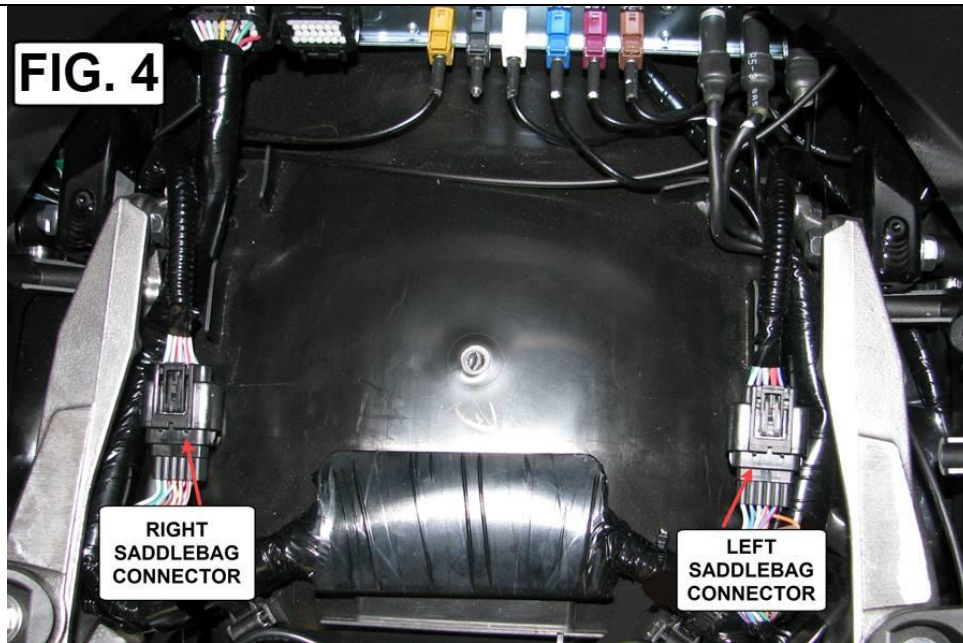

**FIG. 5**

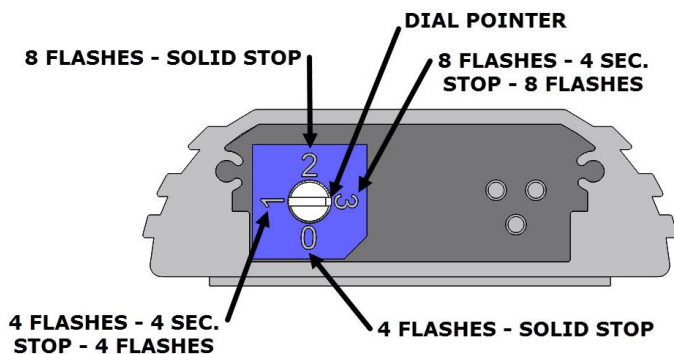
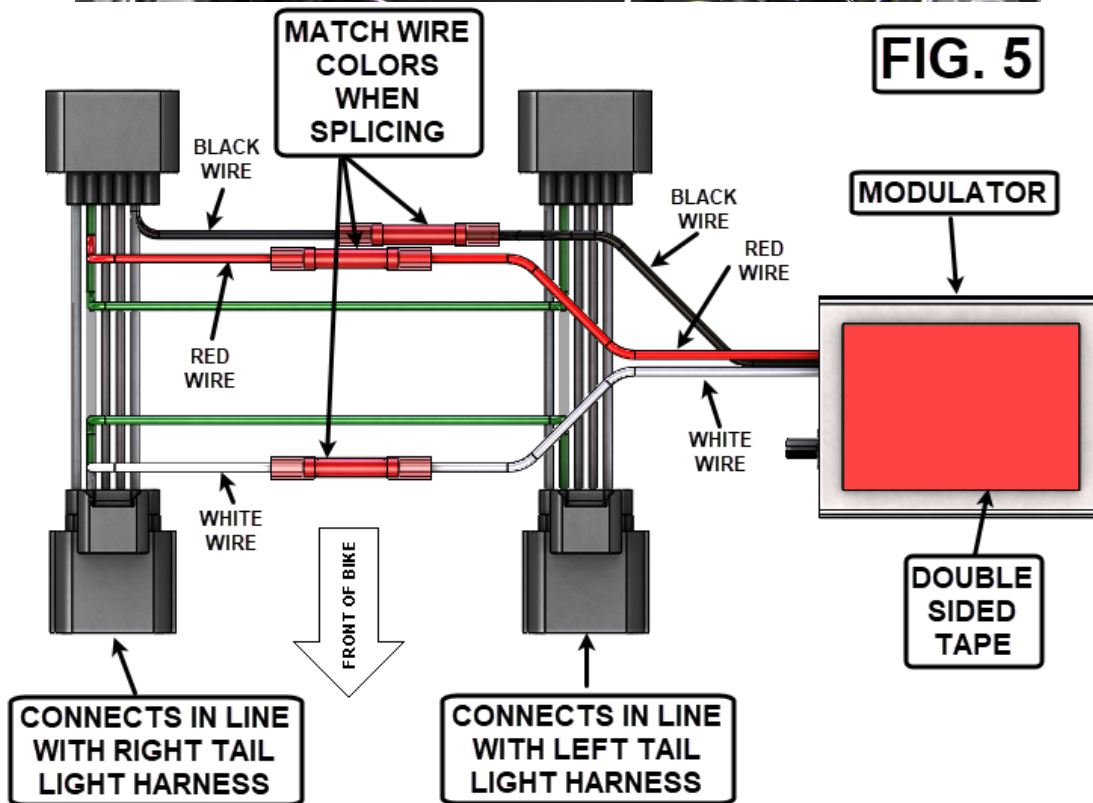

**FIG. 6**

**NOTICE**

IGNORING THE CONTENTS OF THESE INSTRUCTIONS MAY AFFECT THE PRODUCT PERFORMANCE AND FUNCTIONALITY. NOT FOLLOWING THESE INSTRUCTION MAY CAUSE DAMAGE TO THE PRODUCT OR THE VEHICLE TO WHICH IT IS BEING ATTACHED.