

INSTALLATION GUIDE	ITEM / DESCRIPTION	PART NO.	MODEL
	DYNAMIC LED TRUNK SPOILER WITH SEQUENTIAL TURN SIGNALS	G21HTL	GL1800 2021-2023

LIST OF HARDWARE

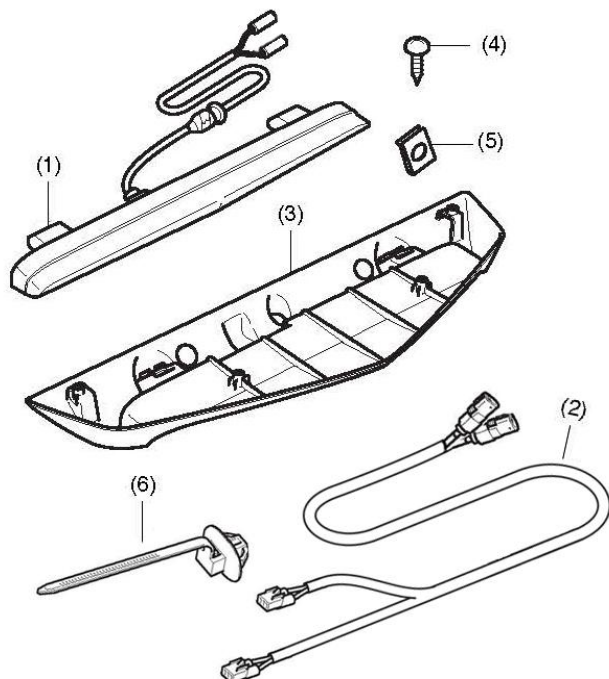

	Description	Qty
1	High mount LED light	1
2	Trunk sub harness	1
3	High mount LED light base	1
4	5 mm stainless screw	6
5	Spring nut	2
6	Push mount tie	2
Digital Files		
►	Installation Guide (Online PDF file)	1

REQUIRED TOOLS & SUPPLIES

Hex wrench (5 mm), Phillips or JIS screwdriver,
Torque wrench, Electric drill, Drill bit (10 mm and 5mm),
Awl, Ruler, Masking tape, Isopropyl alcohol, Shop towel,
Gaffer tape (Black), Wire ties.

REQUIRED PARTS - sold separately

CHROME TRUNK RACK (P/N: HONDA 08L70-MKC-L00)

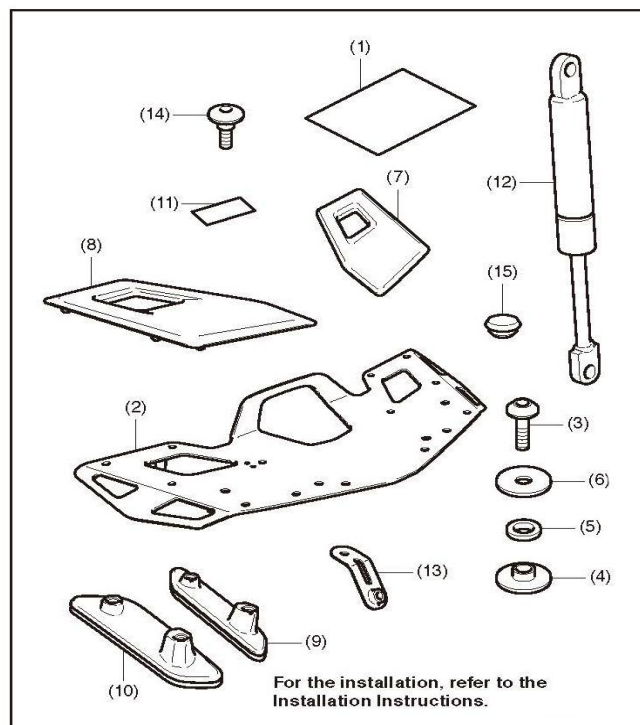

REQUIRED PARTS - sold separately

POWER DISTRIBUTION HUB - [P/N: PAH60GW]



Or you can use a compatible power accessory hub.

WIRE HARNESS DEFINITION (P/N: PAH60GW)

Red ==> Brake
White ==> Running
Yellow ==> Right turn signal
Blue ==> Left turn signal
Black ==> Ground (-)

TORQUE CHART

Item	N-m	kgf-m	lbf-ft
5 mm screw	4.2	0.4	3.1
6 mm screw	9	0.9	6.6
6 mm bolt	10	1.0	7

INSTALLATION PREP/STEPS:

Prior to start, review entire guide.

- Allow motorcycle (engine, radiator, exhaust, etc.) to cool down before performing installation.
- Place motorcycle on center stand.
- Disconnect the negative (-) cable from the battery.
*Be aware that the memory, including clock and radio, will be lost when you disconnect the negative (-) cable.
- Tighten the screws, bolts and nuts securely. Refer to the Honda Service Manual for the torque values.
- Reset the clock and radio settings after reconnecting the battery.

NOTE:

The adhesive reaches full adhesion in 72 hours.

Wait at least 24 hours before riding your motorcycle.

1. Perform steps 1 to 30 on the chrome trunk rack installation instructions manual:
(Honda P/N: 08L70-MKC-L00).
2. Perform steps 32 to 40 on the chrome trunk rack installation instructions:
(Honda P/N: 08L70-MKC-L00)
3. Install the spring nuts as shown.

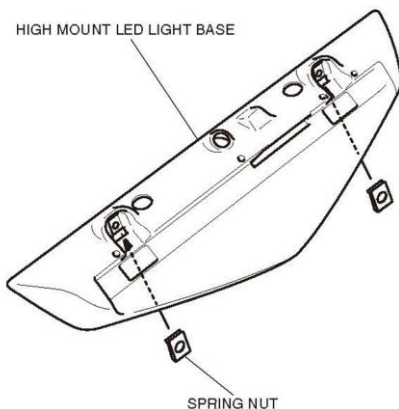

4. Mark the high mount LED light harness in the position shown.

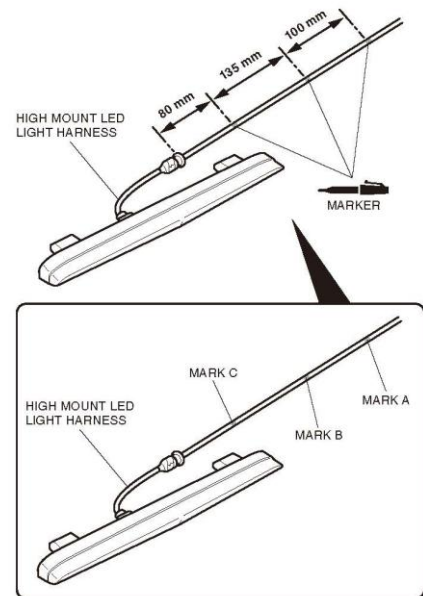

5. Route the high mount LED light harness as shown.

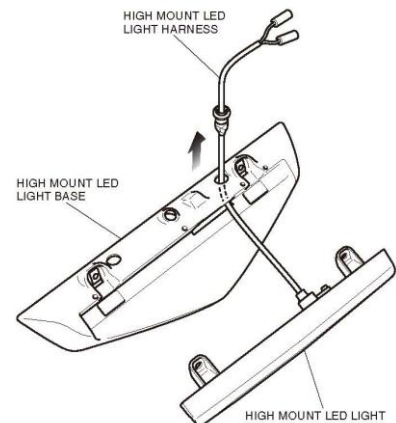

6. Install the high mount LED light as shown.

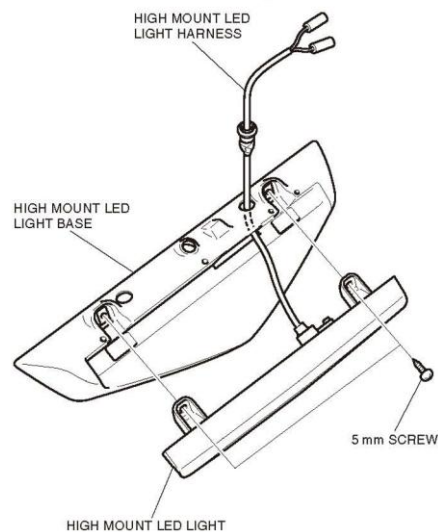

7. Remove the plug as shown below.

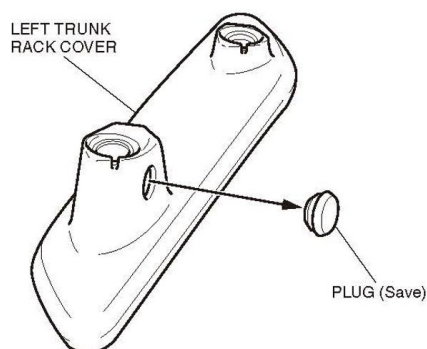

8. Route the high mount LED light harness as shown.



9. Install the high mount LED light harness into the hole as shown.

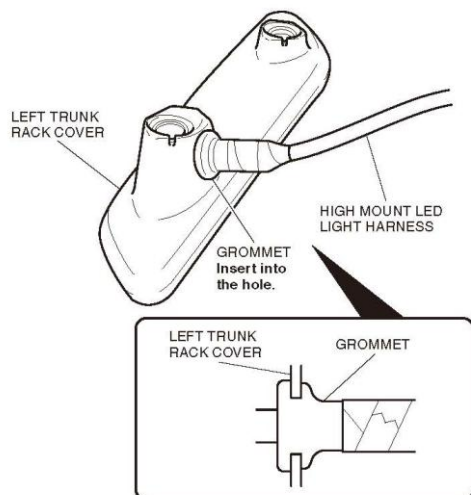

10. Clean the surface of the (grey) area shown using isopropyl alcohol.

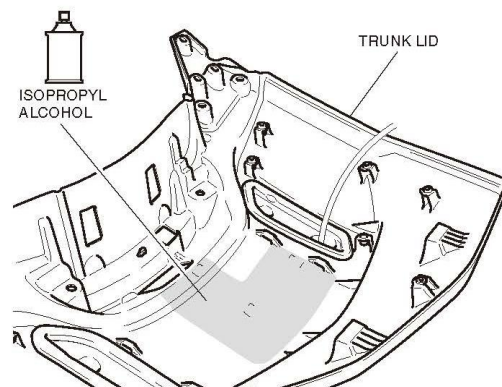

11. Attach the gaffer tapes as shown below.

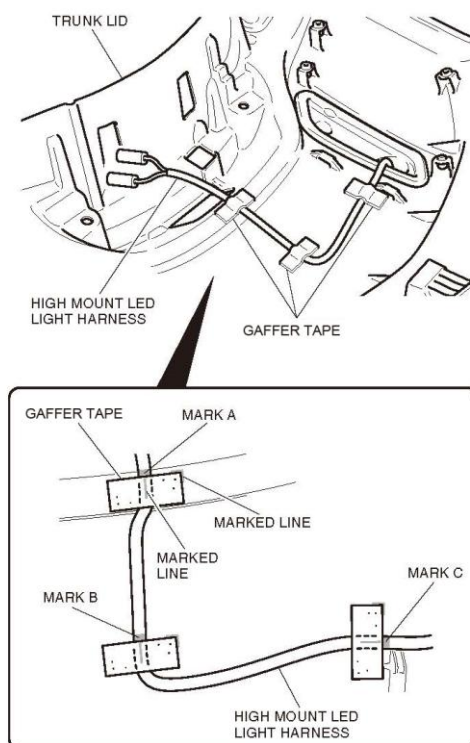

12. Mark the trunk sub-harness in the position shown. Install the PUSH MOUNT TIE at point B and C.

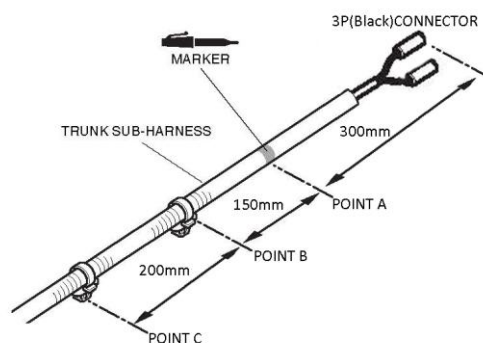

13. Clean the surface of the area shown with isopropyl alcohol.

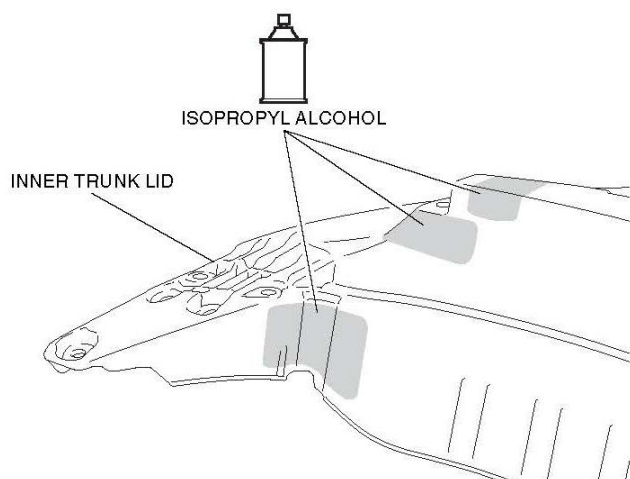

14. Secure the trunk sub-harness with the gaffer tape as shown below.

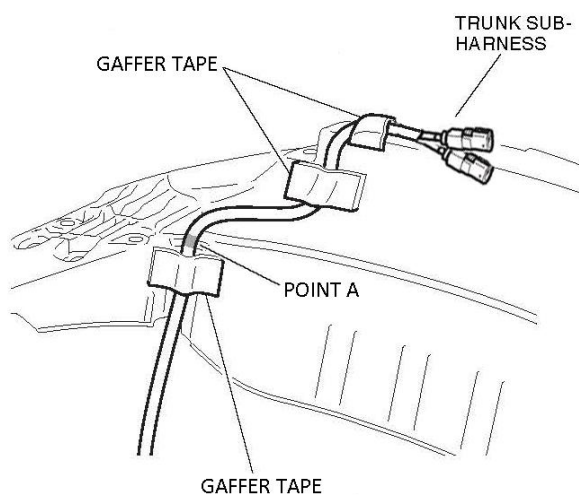

15. Connect the high mount LED light harness and install the inner trunk lid to the trunk lid as shown.
- **Confirm that the wire harness is not caught or too tight.**

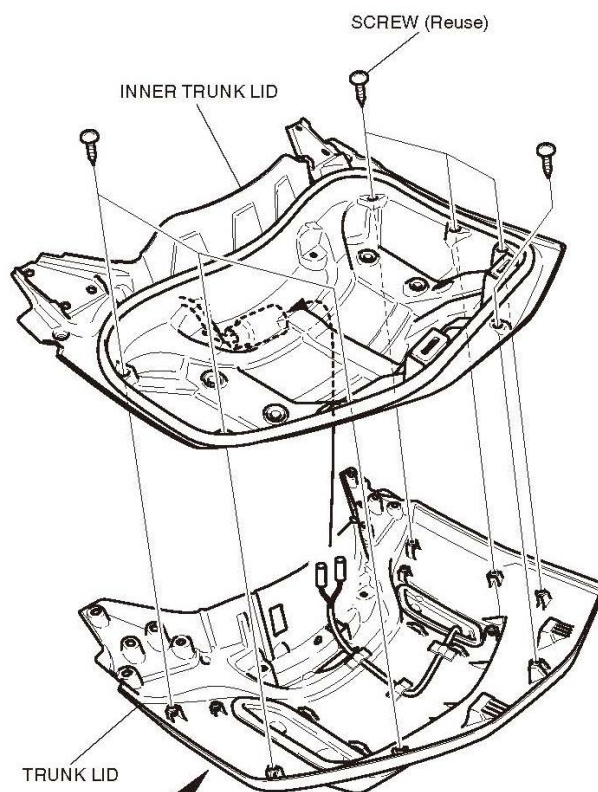

16. Store the terminal in the position as shown.

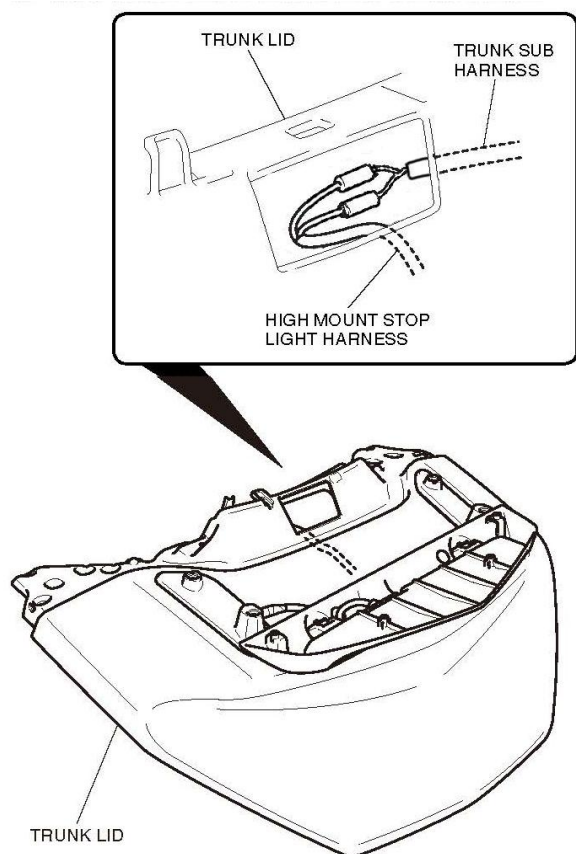

18. Install the rubber washers as shown.

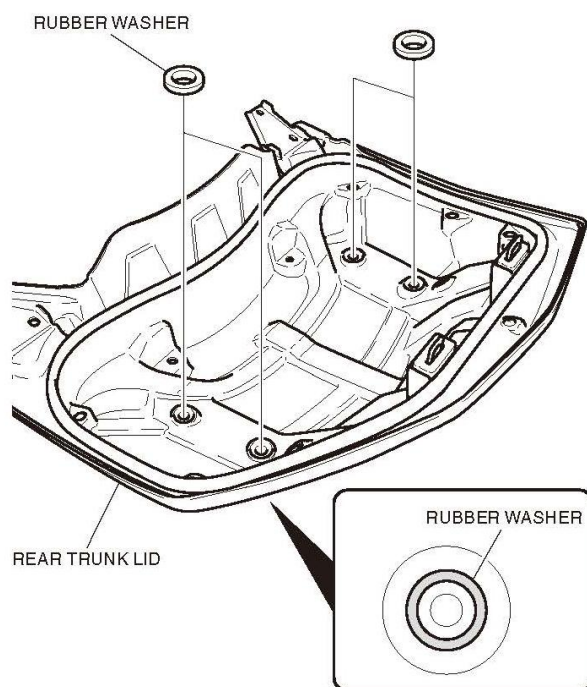

17. Install the striker rods as shown below.

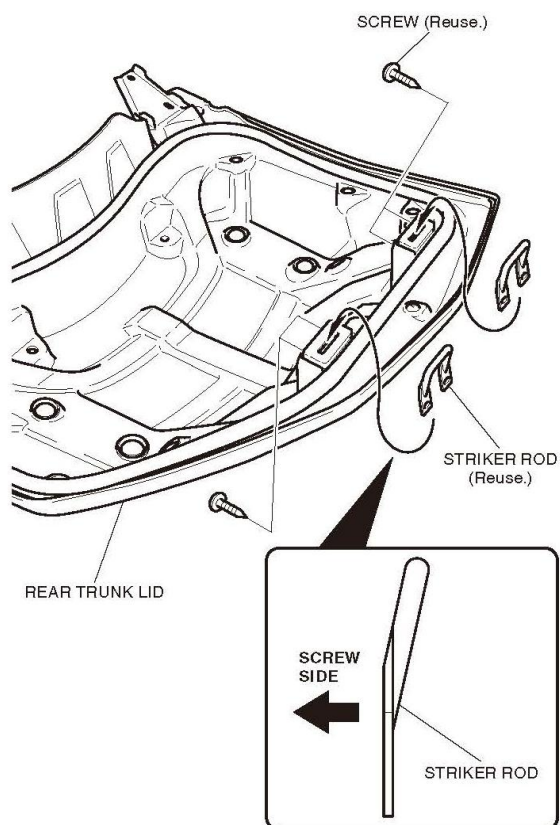

19. Apply dish soap solution to the areas shown.

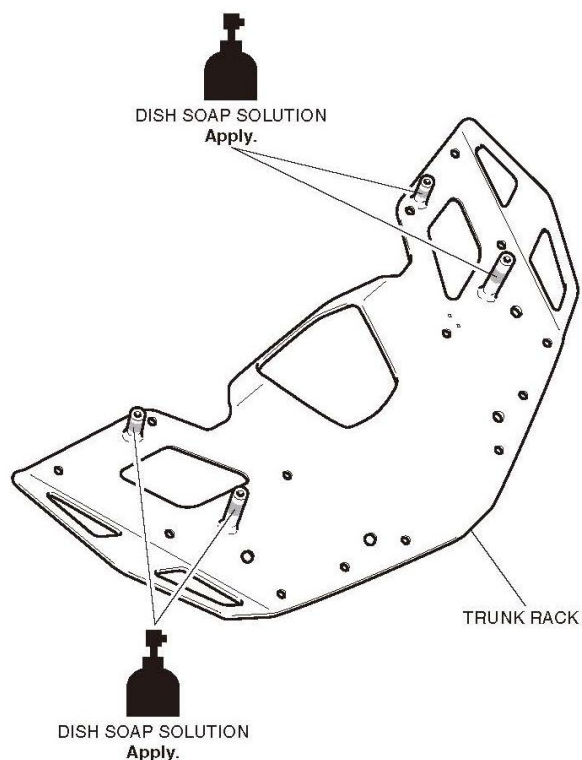

20. Install the trunk rack as shown.

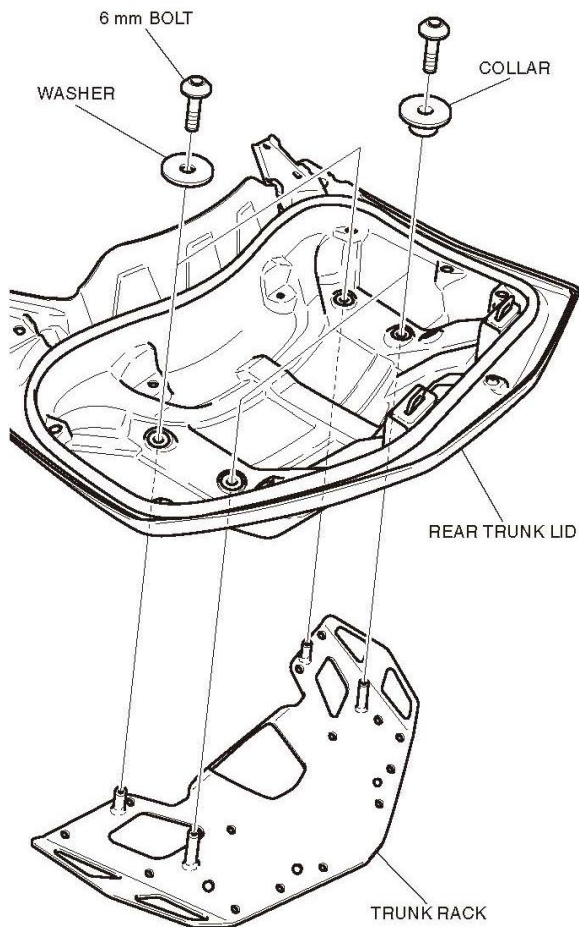

21. Install the high mount LED light as shown.

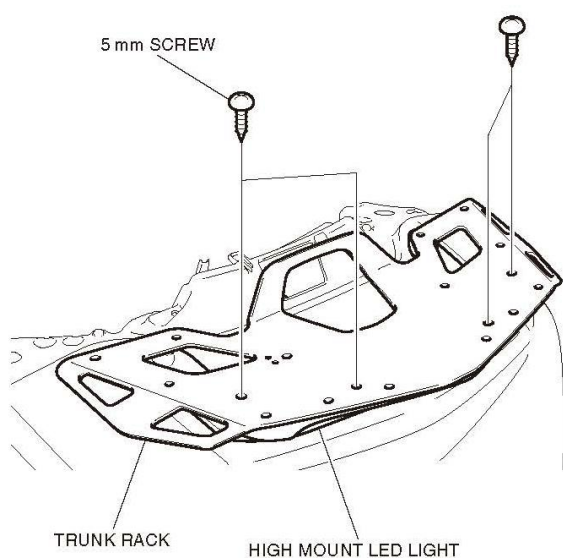

22. Install the LEFT rack top cover as shown.

- Repeat on the RIGHT side.

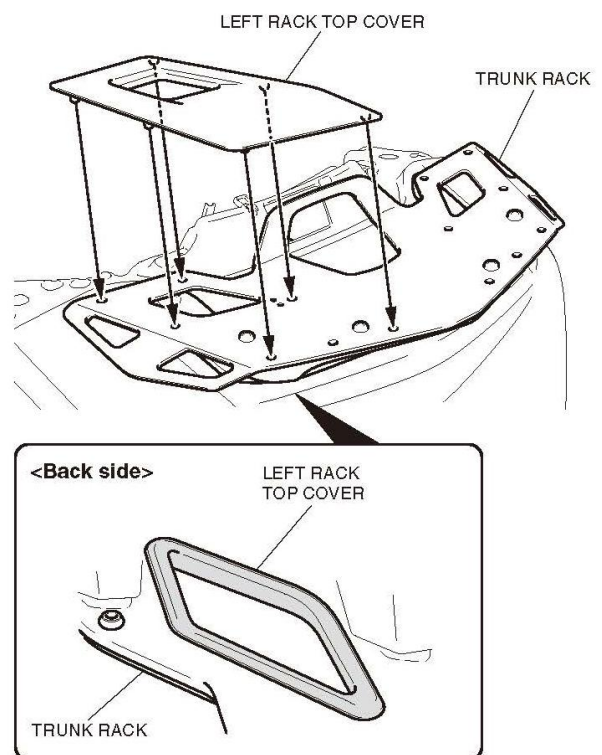

23. Install the REAR trunk lid in the reverse order of removal.

24. Clean the surface of the area shown with isopropyl alcohol.

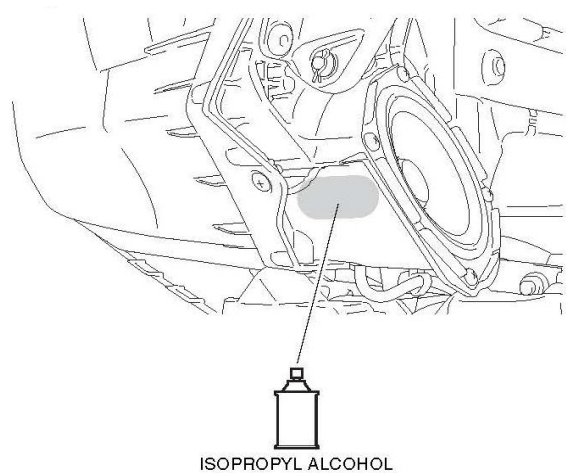

25. Secure the trunk sub-harness as shown.

[RIGHT side]

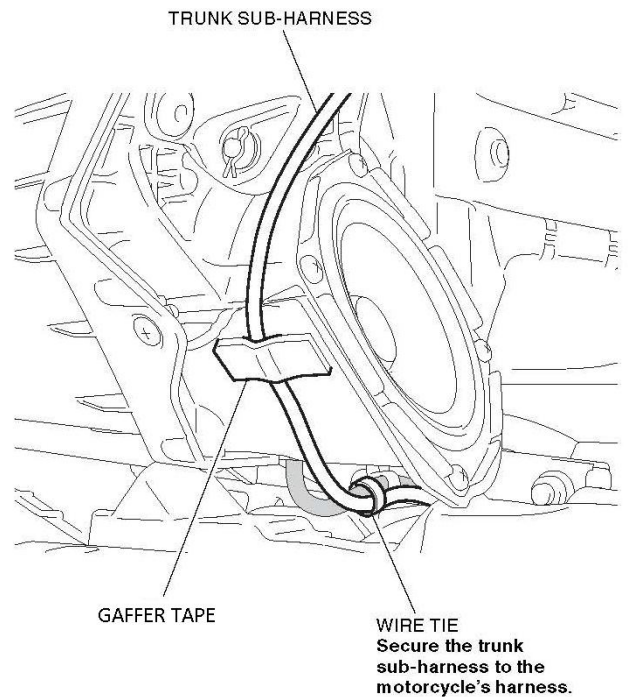
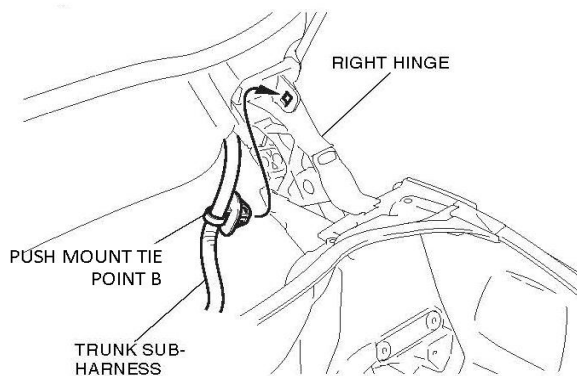

26. Route and secure the trunk sub-harness as shown.

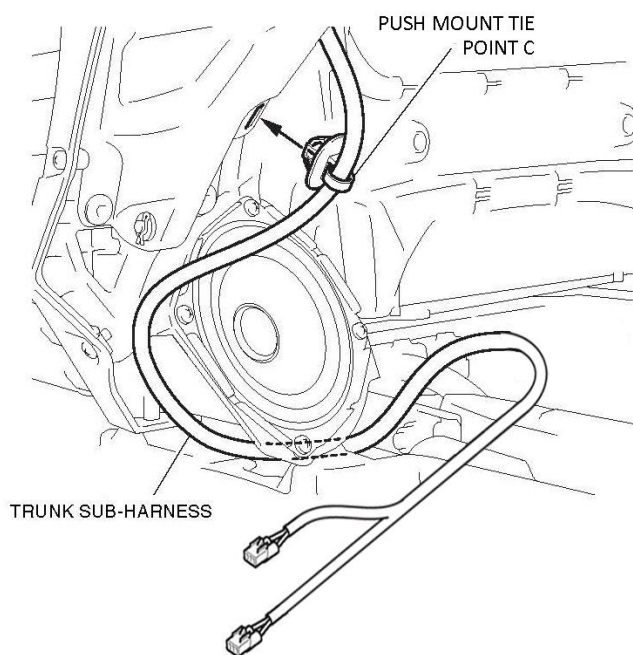

29. Check the LED brake light, headlight, and other lights for proper operation and that no wiring is caught or too tight BEFORE putting the motorcycle back together.

30. Install the motorcycle's parts in the reverse order of removal.

=== INSTALLATION COMPLETE ===

27. Route the trunk sub-harness under the frame and connect to the PAH60GW (sold separately).

- **Confirm that any wire harness is not caught or too tight.**

28. Secure the trunk sub-harness as shown.

YouTube Installation Video available:

[socalmotogear.com/G21HTLVIDEO](https://www.youtube.com/watch?v=socalmotogear.com/G21HTLVIDEO)



This Installation Guide is provided online:

[socalmotogear.com/G21HTLMANUAL](https://www.socalmotogear.com/G21HTLMANUAL)

